

# ALIGNING- AND TRYOUT PRESS UNIT

201.98.

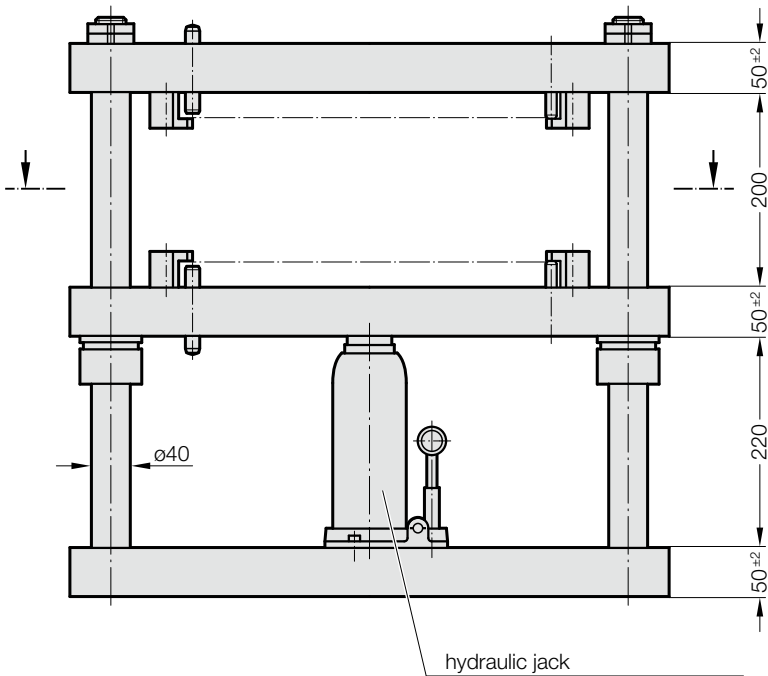

**Description:**

The set-up and testing press with manual operation is used for presetting and testing the insertion tools for the quick-change tool frame. The positioning and clamping functions are the same as in the quick-change frame, but in a simplified version. Moreover the press units provide ideal facilities for the press-fitting of pillars and bushes etc. – or their removal. For bluing-in and tryout of all sorts of press tools they soon prove themselves as an indispensable workshop facility. Pressing force up to 10 t.

**Material:**

Plates: St 52-2

**Execution:**

Headed ball bearing guide bushes,  
hydraulic jack,  
10 tons capacity

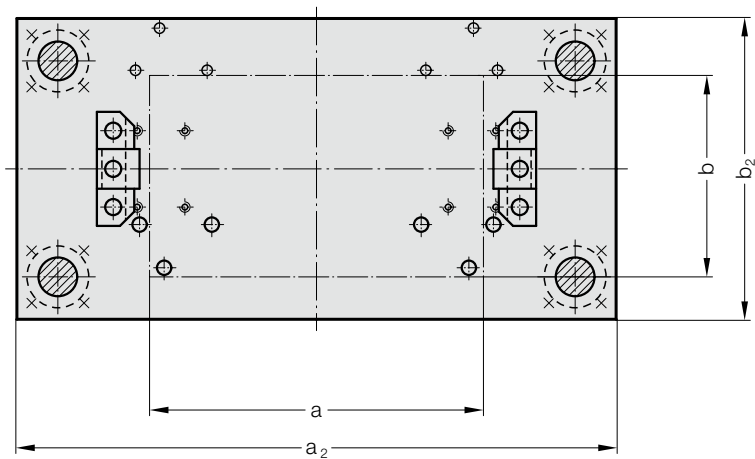

**201.98. Aligning- and Tryout Press Unit**

Order No	Work area a x b	a <sub>2</sub>	b <sub>2</sub>
201.98.1010.863	100 x 100	315	250
201.98.3030.863	210 x 210, 300 x 300, 350 x 210	630	315