

GUIDE BUSH, BRONZE WITH SOLID LUBRICANT

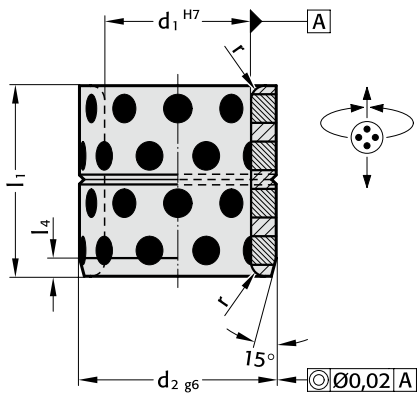

3120.70.



Material:

Bronze with solid lubricant, oilless lubricating

Note:

Bushes can be used with radial or axial motion.

 Assembly guide lines / Dimensional requirements and tolerances at the end of chapter D.

Fixing:

Connecting with adhesive or if needed secure with threaded pin or flat mushroom head screw 2192.61.

3120.70. Guide bush, Bronze with solid lubricant

d ₁	8	10	10	12	13	14	15	16	18	20	20	20	24	25	25	25	28	30	30	30	30	31.5	32	35	35	38	40	40
d ₂	12	14	15	18	19	20	21	22	24	28	26	30	32	35	32	33	38	38	40	42	40	42	45	44	48	50	55	
r	0.5	0.5	0.5	0.5	0.5	0.5	0.75	0.75	0.75	0.75	0.75	0.75	0.75	0.75	0.75	0.75	0.75	0.75	0.75	0.75	0.75	0.75	0.75	0.75	1.5	1.5	1.5	
l ₄	2	2	2	2	2	2	2	2	2	4	4	4	4	4	4	4	4	4	4	4	4	4	4	4	4	4	4	
l ₁																												
8	●	●																										
10	●	●	●	●	●	●	●	●																				
12	●	●		●		●	●	●																				
15	●	●		●	●	●	●	●	●	●																		
16				●	●	●	●	●		●	●			●		●												
20		●		●	●	●	●	●	●	●			●	●		●		●	●				●			●		
25				●		●	●	●	●	●			●	●		●		●	●				●	●		●	●	
30				●		●	●	●	●	●			●	●		●	●	●	●		●	●		●	●	●	●	
35								●	●	●			●			●		●	●				●	●		●	●	
37										●																		
40								●	●	●	●			●		●	●	●	●			●	●	●	●	●	●	
47													●			●	●	●	●			●	●	●	●	●	●	
50										●				●	●			●	●				●	●		●	●	
60																●		●	●		●		●	●		●	●	
70																										●	●	
77																										●	●	
80																										●	●	

Ordering Code (example):

Guide bush, Bronze with solid lubricant	=3120.70.
Diameter of conduit d ₁	40 mm = 040.
Outer diameter d ₂	55 mm = 055.
Installation length l ₁	25 mm = 025
Order No	=3120.70. 040. 055. 025

GUIDE BUSH, BRONZE WITH SOLID LUBRICANT

3120.70.

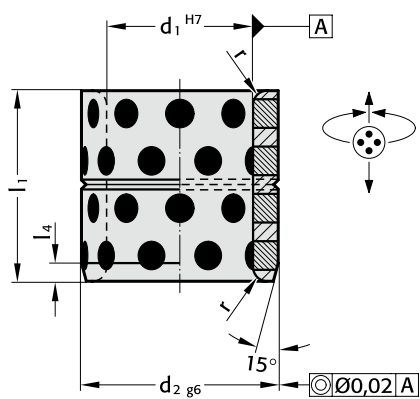

Material:

Bronze with solid lubricant, oilless lubricating

Note:

Bushes can be used with radial or axial motion.

Assembly guide lines / Dimensional requirements and tolerances at the end of chapter D.

Fixing:

Connecting with adhesive or if needed secure with threaded pin or flat mushroom head screw 2192.61.

3120.70. Guide bush, Bronze with solid lubricant

d ₁	45	45	45	50	50	50	55	60	60	63	65	70	70	75	75	80	80	85	90	100	110	120	125	130	140	150	160
d ₂	55	56	60	60	62	65	70	74	75	75	80	85	90	90	95	96	100	100	110	120	130	140	145	150	160	170	180
r	1.5	1.5	1.5	1.5	1.5	1.5	2	2	2	2	2	2	2	2	2	2	2	2	2	2	2	2	2	2	2	2	2
l ₄	4	4	4	4	4	4	4	4	4	4	4	4	4	4	4	4	4	4	4	4	4	4	4	4	4	4	4
l ₁																											
30	•	•	•	•	•	•		•	•																		
35	•	•	•	•	•			•	•			•															
40	•	•	•	•	•	•	•	•	•			•					•	•									
50	•	•	•	•	•	•	•	•	•		•	•	•				•	•									
60	•	•	•	•	•	•	•	•	•	•	•	•	•	•	•	•	•	•	•	•	•	•	•	•	•	•	•
70				•	•	•	•	•	•	•	•	•	•	•	•	•	•	•	•	•	•	•	•	•	•	•	•
80			•	•	•	•	•	•	•	•	•	•	•	•	•	•	•	•	•	•	•	•	•	•	•	•	•
95				•																							
100					•				•			•		•	•	•	•	•	•	•	•	•	•	•	•	•	•
120										•						•	•		•	•	•	•	•	•	•	•	•
130																•	•		•	•	•	•	•	•	•	•	•
140																	•		•	•	•	•	•	•	•	•	•
150																				•	•	•	•	•	•	•	•

Ordering Code (example):

Guide bush, Bronze with solid lubricant	=3120.70.
Diameter of conduit d ₁	40 mm = 040.
Outer diameter d ₂	55 mm = 055.
Installation length l ₁	25 mm = 025
Order No	=3120.70. 040. 055.025