

Gauge pin DIN 2269

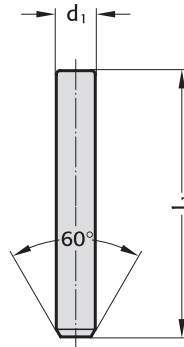

240.1./2.



Material:

Alloy tool steel, hardened and tempered.
Age-treated repeatedly.
Hardness 60 ± 2 HRC

Execution:

precision ground
Quality class I: diameter tolerance $\pm 0,001$
Quality class II: diameter tolerance $\pm 0,002$

Single pins:

Quality class I 240.1.
Quality class II 240.2.

Small set:

91 gauge pins from \varnothing 1-10 mm in steps of 0,1 mm, complete in wooden box.
Quality class I 240.51.
Quality class II 240.52.

Large set:

273 gauge pins from \varnothing 1-10 mm in steps of 0,1 mm, plus one each. 0,01 mm-oversize/undersize pin – complete in wooden box
Quality class I 240.41.
Quality class II 240.42.

Special sets:

Supplied to customer's requirements in respect of assortment and quality class. All gauge pins from \varnothing 3 mm upward are marked with their actual size.

Ordering Code (example):

Gauge pin DIN 2269	=240.
Quality class KL	1 = 1.
Diameter d_1	0.29 mm = 0029
Order No	=240. 1. 0029

240.1./2. Gauge pin DIN 2269

d_1	l_1
0.29 - 6	50
6.01 - 20	70

Direct gauging of bore diameters

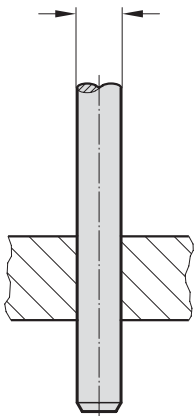

Measurement of centre-distance between two bores

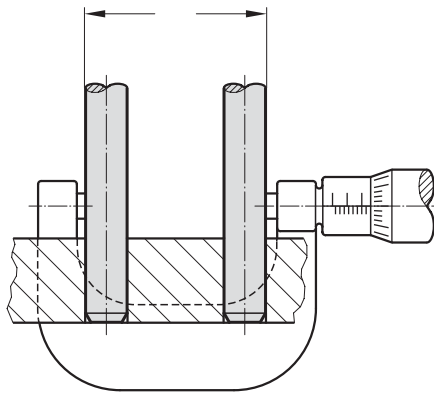

Concentricity check on a bush

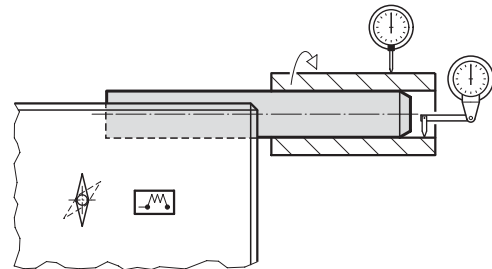

Measurements on prismatic faces

