

BALL-LOCK PUNCH, PUNCH LARGER THAN SHAFT, RECTANGULAR, WITH EJECTOR PIN, LIGHT DUTY

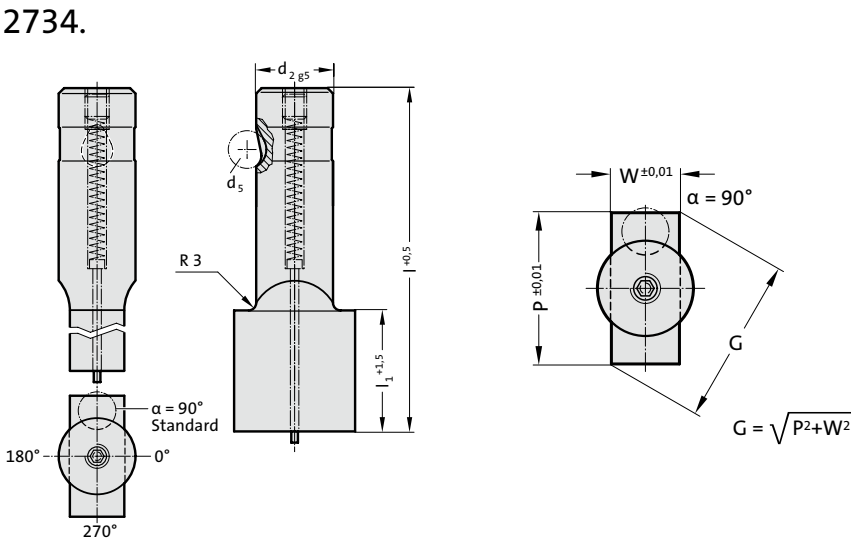

2734. Ball-Lock punch, punch larger than shaft, rectangular, with ejector pin, light duty

| d ₂ / Order No | d ₅ | W _{min} | G _{max} | l ₁ / Order No | (Order Code character) | 80 (E) | 90 (F) | 100 (G) |
|---------------------------|----------------|------------------|------------------|---------------------------|------------------------|-----------|-----------|------------|
| 13 / (3) | 8 | 5 | 32 | 19(2) 30(4) | | ● | ● | ● |
| 16 / (4) | 8 | 6.5 | 38 | 19(2) 30(4) | | ● | ● | ● |
| 20 / (5) | 8 | 8 | 40 | 19(2) 30(4) | | ● | ● | ● |
| 25 / (6) | 8 | 10 | 44 | 19(2) 30(4) | | ● | ● | ● |
| 32 / (7) | 8 | 11.5 | 50 | 19(2) 30(4) | | ● | ● | ● |

Material:

HSS
Hardness 62 ± 2 HRC

Execution:

Shaft and punch shape fine ground.
Special dimensions on request.

Note:

With kerf ≤ 0.04 mm, FIBRO rounds off sharp edges if the punch and piercing die bush are ordered together. This reduces the fitting time and the risk of an edge break during operation.

Ordering Code (example):

2734.7F2.3820.1150.B

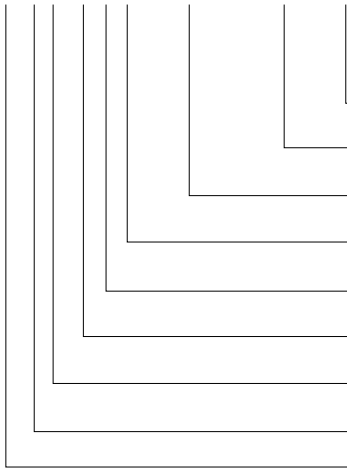

| | |
|---|--------------------------------------|
| Angle: 90° | Order Code character = (B) |
| Shape: rectangular, Width W W = 11,5 mm | = 1150 |
| Shape: rectangular, Length P P = 38,2 mm | = 3820 |
| Punch cutting length: l₁ 19 mm | Order No = (2) |
| Length: l 90 mm | Order Code character = (F) |
| Diameter: d₂ 32 mm | Order No = (7) |
| Type: punch larger, light | Order No = (4) |
| Execution: rectangular | Order No = (3) |
| Punch: with ejector pin | = 27 |